



3-way jaw bearing chuck double acting/single acting

# CKG Series

- Operational stroke length: 6, 8, 11, 16mm



## Specifications

Descriptions		CKG				
Size		16CS	25CS	32CS	40CS	50CS
Cylinder bore size	mm	φ 16	φ 25	φ 32	φ 40	φ 50
Actuation		Double acting/single acting				
Working fluid		Compressed air				
Max. working pressure	MPa	0.7				
Min. working pressure <sup>Note</sup> MPa	Double acting	0.1				
	Normally open	0.3				
	Normally closed					
Ambient temperature	°C	5 to 60				
Port size		M5				
Operational stroke length	mm	6		8	11	16
Rod diameter	mm	φ 9	φ 10	φ 14	φ 18	φ 20
Capacity of reciprocating	cm <sup>3</sup>	1.0	2.2	5.1	10.1	36.1
Repeatability	mm	± 0.01				
Product weight	kg	0.24	0.47	0.80	1.4	2.3
Lubrication		Not required (use turbine oil Class 1 ISO VG32 for lubrication)				

Note: When rubber cover (option), Min. working pressure is to be 16CS : 0.2MPa, 25CS to 50CS: 0.15MPa.

## Switch specifications

Descriptions	Proximity 2 wire	Proximity 3 wire
	T2H/V	T3H/V
Applications	Programmable controller	Programmable controller, relay
Output method	-	NPN output
Power voltage	-	10 to 28 VDC
Load voltage/current	10 to 30 VDC, 5 to 20mA (Note 2)	30 VDC or less, 100mA or less
Light	LED (ON lighting)	
Leakage current	1mA or less	10μA or less

Note 2: Max. load current above: 20 mA at 25°C. If ambient temperature around switch is higher than 25°C, 5 to 10mA at 60°C for T2 type, while 5 to 15mA at 60°C for S2 type.

### How to order

Without switch

**CKG** - **16CS** - **O**

With switch

**CKG** - **16CS** - **O** - **T2H** - **R**

**A** Size

**B** Option  
Note 1, Note 2

**C** Switch model no.  
Note 3

**D** Switch quantity

### ⚠ Note on model no. selection

Note 1: Y11 and Y21 are available for CKG-16CS, while Y11, Y12, Y21 and Y22 are available for CKG-25CS to 40CS, and Y11 and Y21 are available for CKG-50CS.

Note 2: Refer to pages 494 to 497 for the dimensions and applicable model of the small jaw. When ordering as option, 3 pieces are provided.

Note 3: Switches other than **C** switch model no. are available. (Custom order) Refer to Ending 1 for details.

<Example of model number>

### CKG-16CS-O-T2H-R

Model: Bearing chuck

**A** Size: 16CS

**B** Option: Single acting, normally open type

**C** Switch model no.: Proximity T2H switch, lead wire 1m

**D** Switch quantity: One on open side

How to order switch

(T type switch)

**SW** - **T2H**

Switch model no.  
(Item above **C**)

Only CKG-50CS

- For switch T\*H\*
- Switch body + mounting bracket

**CKG** - **T2H**

Switch model no.  
(Item above **C**)

- For switch T\*V\*
- Switch body + mounting bracket

**CKG** - **T2V** - \*

Switch model no.  
(Item above **C**)

(Select either R (open) or H (closed) for sections marked with an asterisk (\*).)

Only CKG-50CS

- Mounting bracket

**CKG** - **T**

- Mounting bracket

**CKG** - **TV** - \*

Symbol	Descriptions			
<b>A Size</b>				
<b>16CS</b>				
<b>25CS</b>				
<b>32CS</b>				
<b>40CS</b>				
<b>50CS</b>				
<b>B Option</b>				
<b>Blank</b>	Standard (double acting)			
<b>O</b>	Single acting (normally open)			
<b>C</b>	Single acting (normally closed)			
<b>G</b>	Rubber cover (with nitrile rubber)			
<b>Y11</b>	With small jaw material (S50C) Outer mount chuck (small jaw No.: 540 to 710)			
<b>Y12</b>	With small jaw material (S50C) Inner mount chuck (small jaw No.: 610 to 630)			
<b>Y21</b>	With small jaw material (MC nylon) Outer mount chuck (small jaw No.: 510 to 540,710)			
<b>Y22</b>	With small jaw material (MC nylon) Inner mount chuck (small jaw No.: 610 to 630)			
<b>C Switch model no.</b>				
Axial lead wire	Radial lead wire	Contact	Indicator	Lead wire
<b>T2H*</b>	<b>T2V*</b>	Proximity	1 color indicator type	2-wire
<b>T3H*</b>	<b>T3V*</b>			3-wire
<b>*Lead wire length</b>				
<b>Blank</b>	1m (standard)			
<b>3</b>	3m (option)			
<b>5</b>	5m (option)			
<b>D Switch quantity</b>				
<b>R</b>	One on open side			
<b>H</b>	One on closed side			
<b>D</b>	Two			

RRC
GRC
RV3*
NHS
HR
LN
FH100
HAP
BSA2
BHA/ BHG
LHA
LHAG
HKP
HLA/ HLB
HLAG/ HLBG
HEP
HCP
HMF
HMFB
HFP
HLC
HGP
FH500
HLB
HDL
HMD
HJL
BHE
<b>CKG</b>
CK
CKA
CKS
CKF
CKJ
CKL2
CKL2 *-HC
CKH2
CKLB2
NCK/ SCK/FCK
FJ
FK
Ending

3-way jaw bearing chuck  
Chuck

### Dimensions



#### ● CKG-16CS standard/O/C

· Dimensions in ( ) for O [normally open] and C [normally closed] specifications.

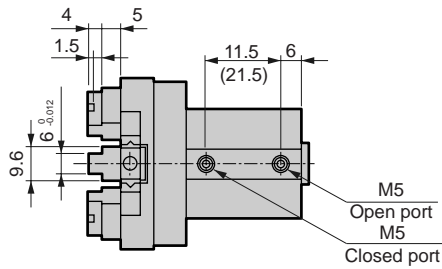

#### ● With switch

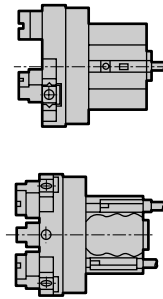

#### ● With rubber cover

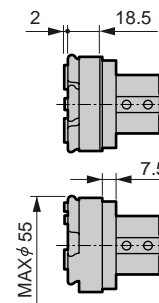
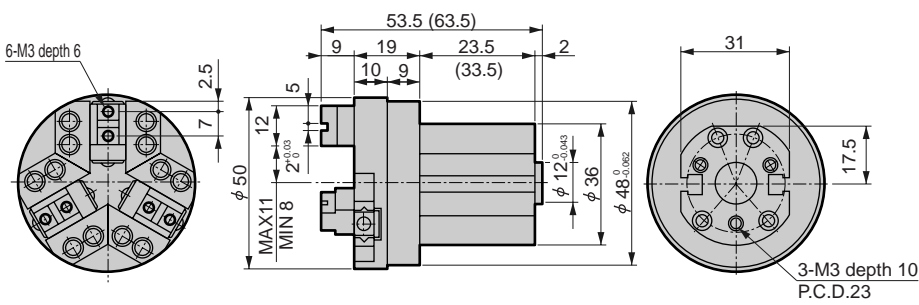

#### ● CKG-25CS standard/O/C

· Dimensions in ( ) for O [normally open] and C [normally closed] specifications.

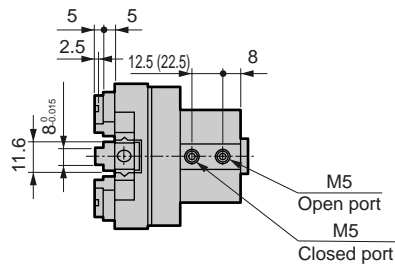

#### ● With switch

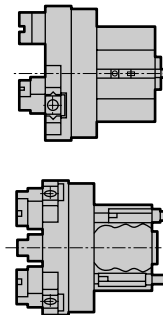

#### ● With rubber cover

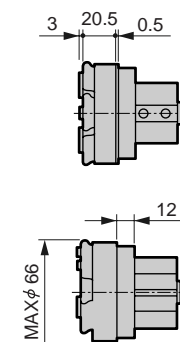
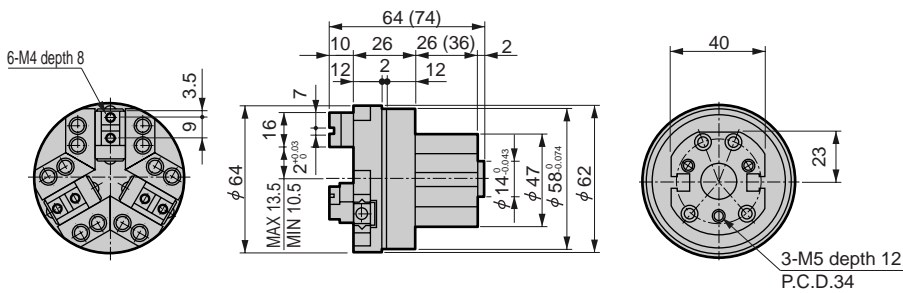

RRC
GRC
RV3*
NHS
HR
LN
FH100
HAP
BSA2
BHA/BHG
LHA
LHAG
HKP
HLA/HLB
HLAG/HLBG
HEP
HCP
HMF
HMFB
HFP
HLC
HGP
FH500
HBL
HDL
HMD
HJL
BHE
<b>CKG</b>
CK
CKA
CKS
CKF
CKJ
CKL2
CKL2 *-HC
CKH2
CKLB2
NCK/SCK/FCK
FJ
FK
Ending

3-way jaw bearing chuck  
Chuck

## Dimensions



RRC
GRC
RV3*
NHS
HR
LN
FH100
HAP
BSA2
BHA/BHG
LHA
LHAG
HKP
HLA/HLB
HLAG/HLBG
HEP
HCP
HMF
HMFB
HFP
HLC
HGP
FH500
HBL
HDL
HMD
HJL
BHE
<b>CKG</b>
CK
CKA
CKS
CKF
CKJ
CKL2
CKL2-*.HC
CKH2
CKLB2
NCK/SCK/FCK
FJ
FK
Ending

### ● CKG-32CS standard/O/C

· Dimensions in ( ) for O [normally open] and C [normally closed] specifications.

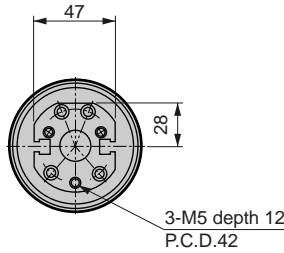
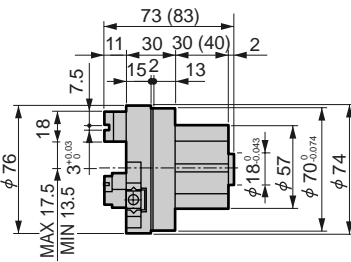
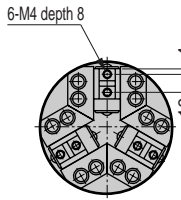
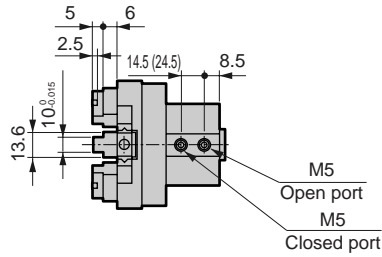

### ● With switch

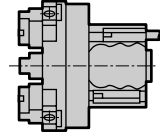
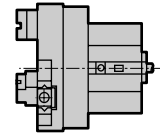

### ● With rubber cover

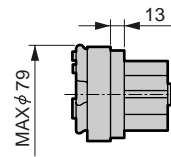
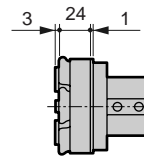

### ● CKG-40CS standard/O/C

· Dimensions in ( ) for O [normally open] and C [normally closed] specifications.

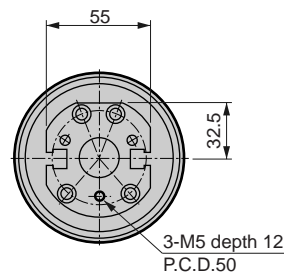
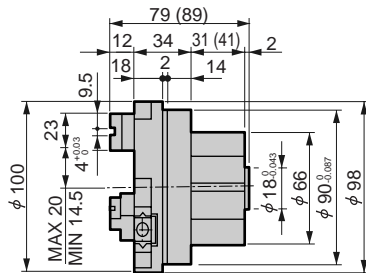
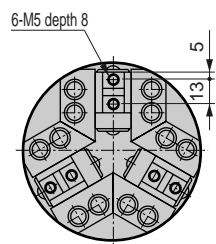
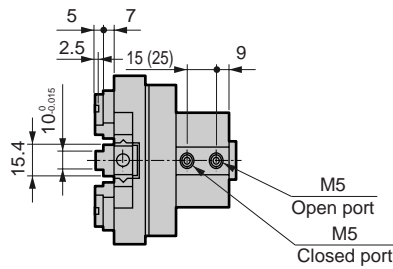

### ● With switch

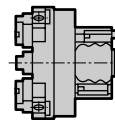
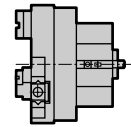

### ● With rubber cover

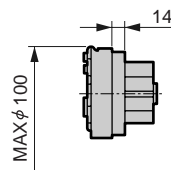
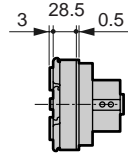

### Dimensions



● CKG-50CS standard/O/C

· Dimensions in ( ) for O [normally open] and C [normally closed] specifications.

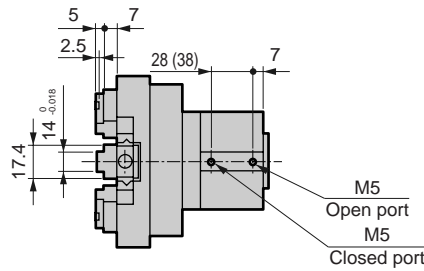

● With switch

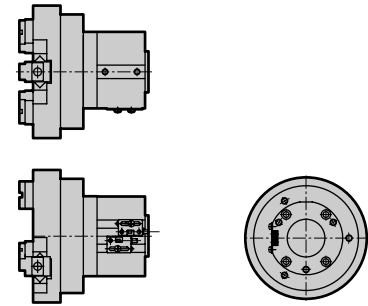

● With rubber cover

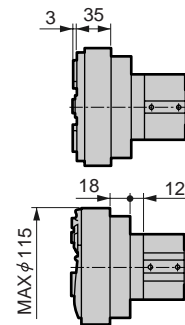

6-M6 depth 10

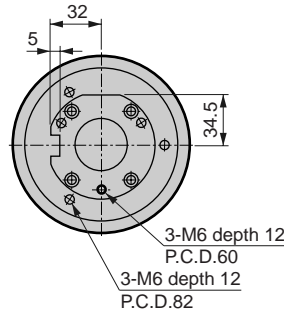
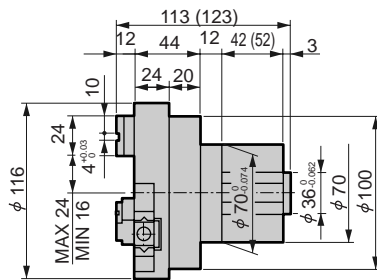
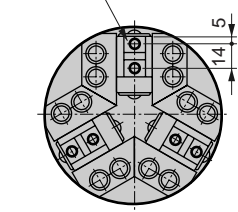

MAX φ 115

RRC
GRC
RV3*
NHS
HR
LN
FH100
HAP
BSA2
BHA/BHG
LHA
LHAG
HKP
HLA/HLB
HLAG/HLBG
HEP
HCP
HMF
HMFB
HFP
HLC
HGP
FH500
HLB
HDL
HMD
HJL
BHE
<b>CKG</b>
CK
CKA
CKS
CKF
CKJ
CKL2
CKL2 *-HC
CKH2
CKLB2
NCK/ SCK/FCK
FJ
FK
Ending

3-way jaw bearing chuck  
Chuck

